

This document must be retained for future reference.

It is the responsibility of the person installing the electrical equipment to ensure that the installation meets the requirements of the IET wiring regulations and is therefore 'fit for purpose'. Factors such as correct selection of components, cable sizing, protective devices and Earth bonding are all critical and should be checked prior to full testing and power-up. Any other regulations applicable to the equipment being installed such as the Machinery Directive and current health and safety legislation must also be adhered to.

All connections (including factory made) must be checked for the correct tightness prior to commissioning of the electrical installation. All connections should also be inspected periodically to ensure correct tightness.

DO NOT USE POWER TOOLS ON THESE PRODUCTS



100A Type 2 SPD SL-HSP

Features & Benefits

- Mounts directly to the Sentinel consumer units busbar next to the main switch
- 100A rated, as this is the same rating as the maximum cut out fuse and the consumer unit, there is no requirement for a separate MCB or fuse to protect it
- Only uses 1 module in the consumer unit allowing for more space for other circuits
- Plug in replacement cartridge, no need to disturb any connections
- Easy and quick to install
- Volt free monitoring contacts for remote monitoring of SPD status
- Status indicator showing when cartridge requires changing:
 - Green - OK
 - Red - Replace

Dimensions

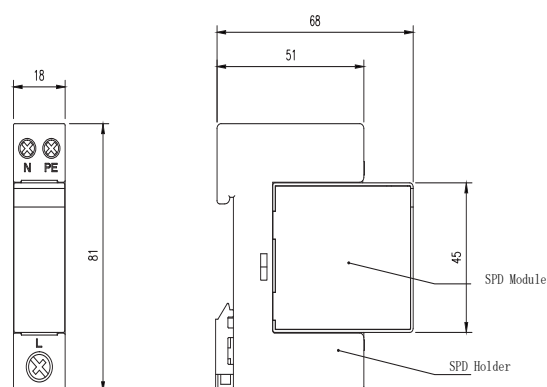

SPD Specification

BS/EN Standard	BS EN/EN 61643-11
Earthing system	TT/TN
Protection Level	Type 2 (T2)
Max. Continuous Operating Voltage U_c	275V AC
Nominal Discharge Current I_n	20kA
Maximum Discharge Current I_{max}	40kA
Voltage Protection Level U_p	1.3kV (L-N/N-PE)
Status Indicator	Green (Normal State)/ Red (Replace cartridge)
Mounting	35mm DIN Rail
Terminal Capacity	Live 16mm ² / Neutral & PE 10mm ²
Terminal Torque	Live 2.0Nm/ Neutral & PE 1.2Nm
Degree of Protection	IP 20
Maximum Back Up Fuse	100A gL/gG

Refer to BS7671, Regulations 534.4.8; 534.4.9 & 534.4.10 when installing the surge protection device with cables which have not been supplied by Europa as part of an SPD Kit