

This document must be retained for future reference.

It is the responsibility of the person installing the electrical equipment to ensure that the installation meets the requirements of the IET wiring regulations and is therefore 'fit for purpose'. Factors such as correct selection of components, cable sizing, protective devices and Earth bonding are all critical and should be checked prior to full testing and power-up. Any other regulations applicable to the equipment being installed such as the Machinery Directive and current health and safety legislation must also be adhered to.

All connections (including factory made) must be checked for the correct tightness prior to commissioning of the electrical installation. All connections should also be inspected periodically to ensure correct tightness.

DO NOT USE POWER TOOLS ON THESE PRODUCTS



230V Switched Interlocked Socket in Keylock enclosure
RCBO Protected

Features & Benefits

- IP65 (accepts IP67 plugs)
- Complete with pre-fitted 30mA 2P Type A RCBO
- Loop in Loop out terminals except in single module versions
- Self-extinguishing – manufactured in fire & shock resistant material
- Includes spirit level to make installation easier
- Four cable inlets M25 / M32 top, bottom and side entry
- Where fitted meters are MID approved

Part Numbers
SISRCBOAW163P
SISRCBOAW323P
SISRCBOAW163P12
SISRCBOAW323P12
SISRCBOAW163P2
SISRCBOAW323P2
SISRCBOAW163PM
SISRCBOAW323PM
SISRCBOAW163P12M
SISRCBOAW323P12M
SISRCBOAW163P2M
SISRCBOAW323P2M
SISRCBOAW163P3
SISRCBOAW323P3
SISRCBOAW163P4
SISRCBOAW323P4
SISRCBOAW163P3M
SISRCBOAW323P3M
SISRCBOAW163P4M
SISRCBOAW323P4M

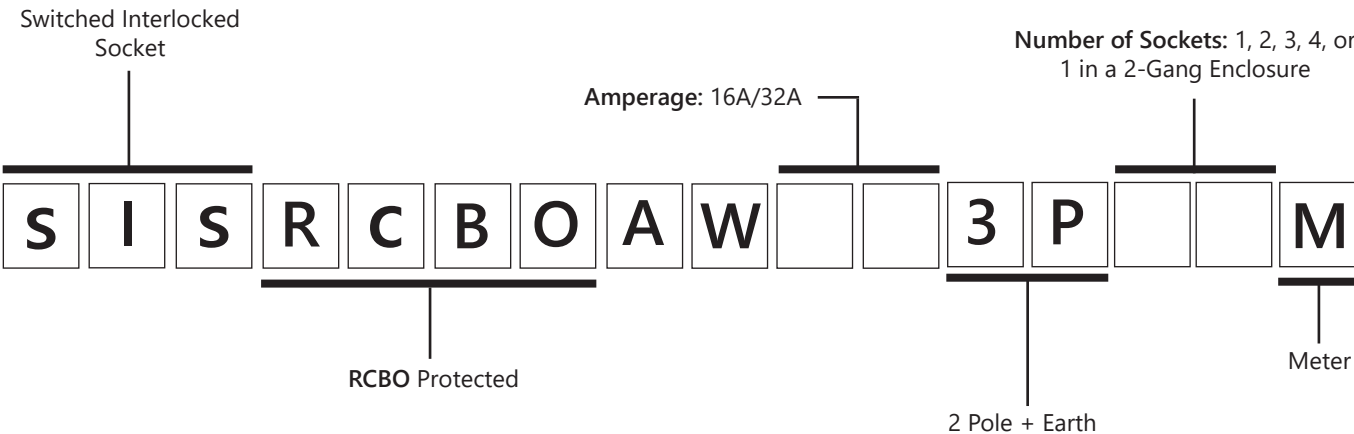

230V Switched Interlocked Socket in Keyblock enclosure RCBO Protected

Accessories
GNDSPK
GS2MODPLATE
GS3MODPLATE
GS4MODPLATE
CHUJOINKIT



CHUJOINKIT

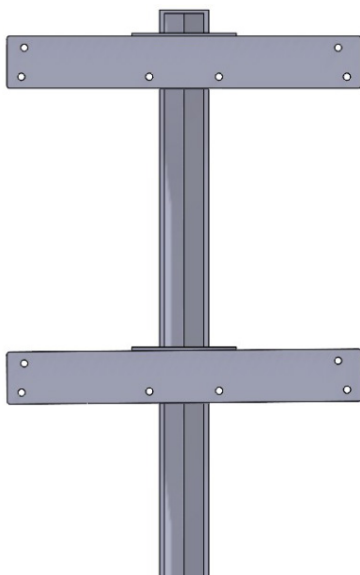

GROUND SPIKE WITH ADAPTER
PLATES

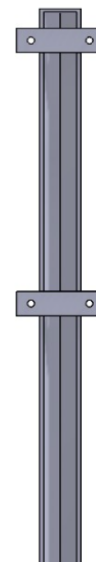

GROUND SPIKE