

This document must be retained for future reference.

It is the responsibility of the person installing the electrical equipment to ensure that the installation meets the requirements of the IET wiring regulations and is therefore 'fit for purpose'. Factors such as correct selection of components, cable sizing, protective devices and Earth bonding are all critical and should be checked prior to full testing and power-up. Any other regulations applicable to the equipment being installed such as the Machinery Directive and current health and safety legislation must also be adhered to.

All connections (including factory made) must be checked for the correct tightness prior to commissioning of the electrical installation.
All connections should also be inspected periodically to ensure correct tightness.

DO NOT USE POWER TOOLS ON THESE PRODUCTS



IP44 63A Surface Sockets

- Conforms to BS IEC 60309-2
- IP44 rated
- Spring-return lid
- Operating temperature: -25 °C to +40 °C

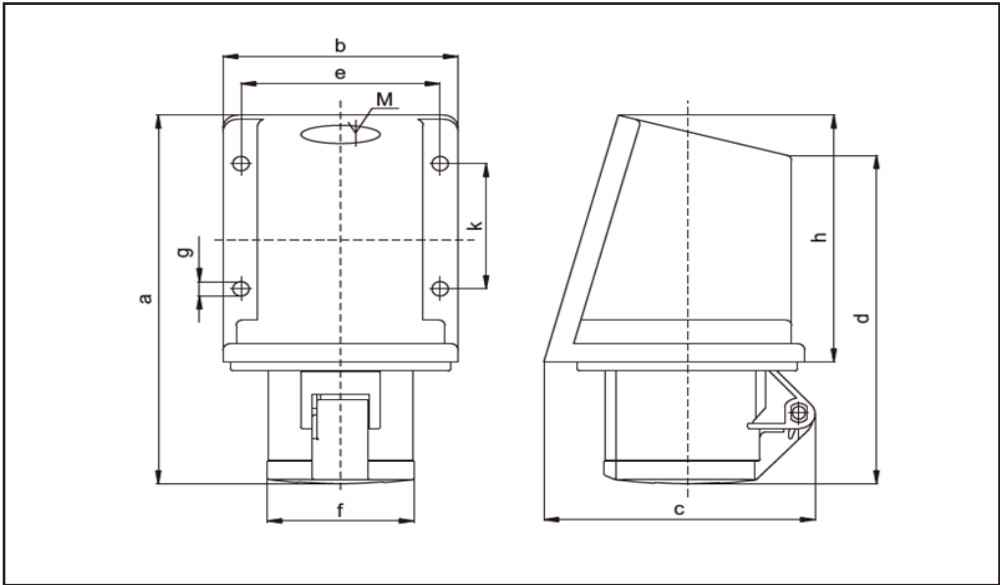

Part Number	Amps	Colour & Voltage	Poles	Protection Degree	a (mm)	b (mm)	c (mm)	d (mm)	e (mm)	f (mm)	g (mm)	h (mm)	k (mm)	m (mm)	Terminal Capacity	Recommended Terminal Torque
ISS633P	63A	Blue 230V	2P + E	IP44	245	109	116	227	97	98	6	140	82	40	10 - 16mm ²	2.0 Nm
ISS634N		Red 415V	3P + E													
ISS635N		Red 415V	3P + N + E													